

### INSTALLATION SECTION VIEW

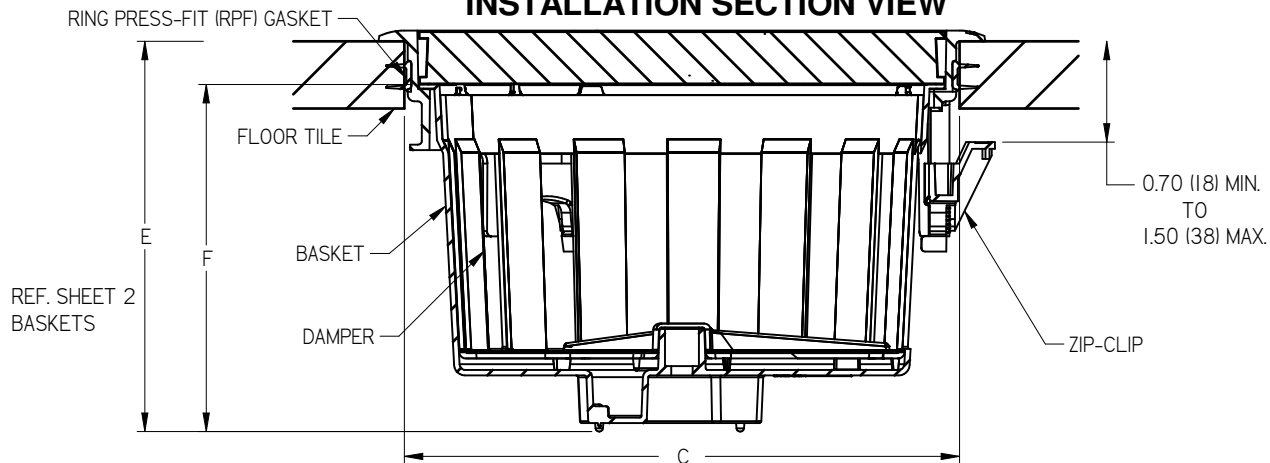

SIZE	DIFFUSER FACE		MOUNTING RING		FLOOR TILE OPENING	TILE CUTOUT CODE
	A		B		C	
	ALUM	POLY	ALUM	POLY	ALUM & POLY	
<input type="checkbox"/> 8R	Ø7.90 (201)	Ø7.82 (199)	Ø9.08 (231)	Ø9.03 (229)	Ø8.50 $\begin{smallmatrix} +.125 \\ -0.00 \end{smallmatrix}$ (216 +3/-0)	A3 OR B3
<input type="checkbox"/> 10R	Ø9.90 (251)	N/A	Ø11.08 (282)	N/A	Ø10.50 $\begin{smallmatrix} +.125 \\ -0.00 \end{smallmatrix}$ (267 +3/-0)	A4 OR B4

#### Floor Tile Cutout Ordering Codes:

- A3 - 8.5" (215.9mm) center cutout
- B3 - 8.5" (215.9mm) corner cutout located 3" (76.2mm) off each corner recommended
- A4 - 10.5" (266.7mm) center cutout
- B4 - 10.5" (266.7mm) corner cutout located 3" (76.2mm) off each corner recommended

#### BASKET OPTIONS: (REFERENCE SHEET 2 FOR VARIOUS OPTIONS)

- ☐ NO BASKET OPTION

#### FASTENING OPTIONS:

- ☐ ZIP-CLIP (ZC)

#### FEATURES:

- COMPONENTS SHIPPED ASSEMBLED
- NFPA 90B COMPLIANT
- TABS ON MOUNTING RING SECURE DIFFUSER FACE
- POLYMER IS FIRE RATED (UL 94/2043)
- VBD COMES WITH 24VAC ACTUATOR, RJ12 INTERFACE, AND PLENUM RATED CONTROL CABLE

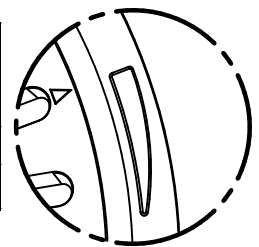

ALUM RING ADJ DIAL

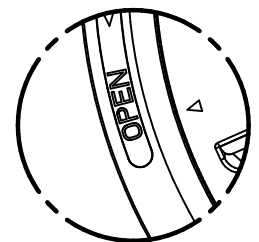

POLY RING ADJ DIAL

Project Name and Number:

Description: **VSD - Vertical Swirl Diffuser**

Engineer:

Submission  
Date:

PROPRIETARY AND CONFIDENTIAL  
THE INFORMATION CONTAINED IN THIS  
DRAWING IS THE SOLE PROPERTY OF  
Global IFS. ANY REPRODUCTION IN PART  
OR AS A WHOLE WITHOUT THE WRITTEN  
PERMISSION OF Global IFS IS PROHIBITED

Dwg Release: 272693 Sheet: 1 Size: Letter

NOTE: VBD-HP, LMBD, LBD, LB, PDC, BB ONLY AVAILABLE WITH 8" DIFFUSERS

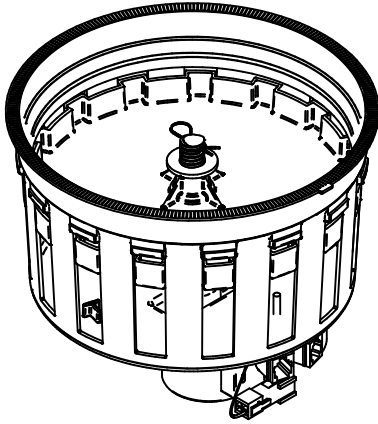

☐ VBD - VAV BASKET & DAMPER (SHOWN)

E = 7.20 (183)  
F = 6.50 (165)

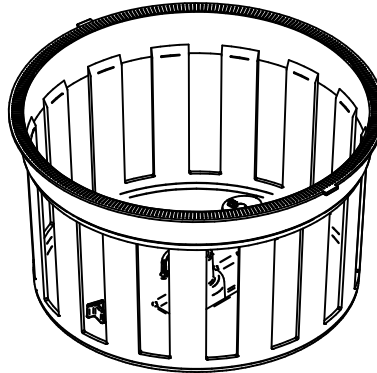

☐ CB - DUST COLLECTOR BASKET

E = 5.85 (149)  
F = 5.25 (133)

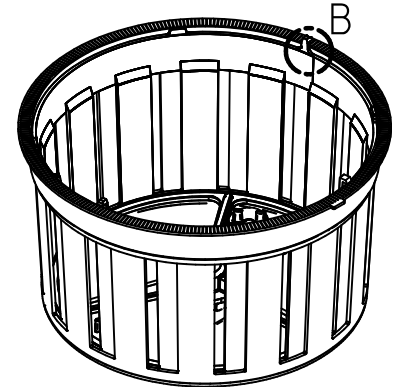

☐ MBD - FACE ADJUSTABLE BASKET & DAMPER

☐ BD - BASKET & DAMPER  
E = 5.85 (149)  
F = 5.25 (133)

☐ VBD-HP - VAV BASKET & DAMPER HIGH PERFORMANCE

MBD - INCLUDES HOOK  
BD - NO HOOK

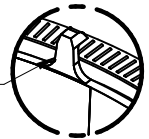

DETAIL B

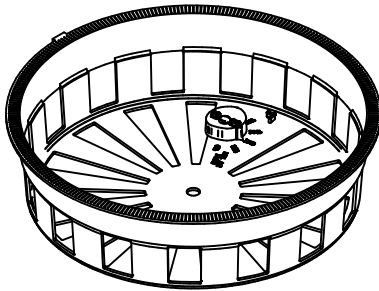

☐ LB - LOW PROFILE BASKET

E = 2.75 (70)  
F = 2.00 (51)

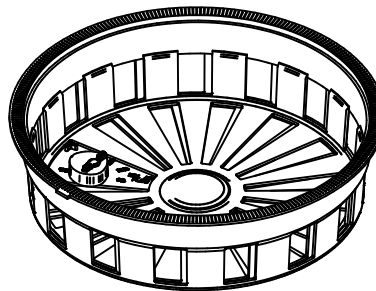

☐ LBD - LOW PROFILE BASKET & DAMPER

E = 2.75 (70)  
F = 2.00 (51)

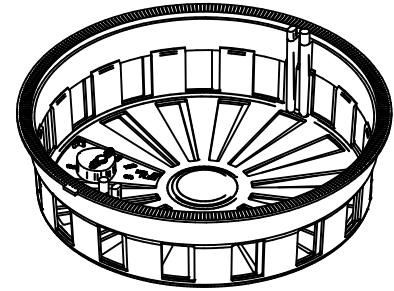

☐ LMBD - LOW PROFILE FACE ADJUSTABLE BASKET & DAMPER

E = 2.75 (70)  
F = 2.00 (51)

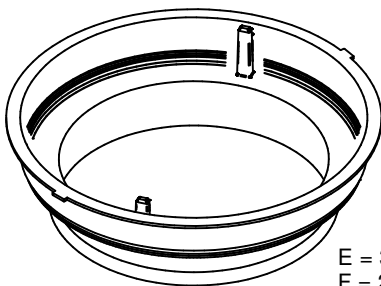

☐ PDC - POLYMER DUCT COLLAR

E = 3.00 (76)  
F = 2.25 (57)

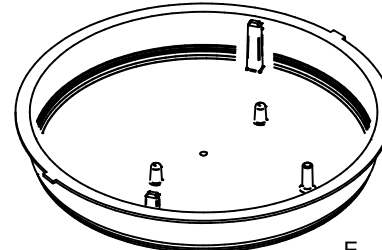

☐ BB - BLANK OFF BASKET

E = 2.30 (58)  
F = 1.65 (42)

Project Name and Number:

Description: **VSD - Vertical Swirl Diffuser**

Engineer:

Submission  
Date:

PROPRIETARY AND CONFIDENTIAL  
THE INFORMATION CONTAINED IN THIS  
DRAWING IS THE SOLE PROPERTY OF  
Global IFS. ANY REPRODUCTION IN PART  
OR AS A WHOLE WITHOUT THE WRITTEN  
PERMISSION OF Global IFS IS PROHIBITED

Dwg Release: 272693 Sheet: 2 Size: Letter

10/19/2020 REV 0